

Dungeness Technical Data

Performance

Net electrical output 550 MW
 Heat output per reactor 835 MW
 Efficiency 32.9%

Reactor gas bulk outlet temperature 410°C
 Reactor gas inlet temperature 250°C
 Nominal max can surface temperature 442°C
 Nominal max uranium temperature 563°C

HP steam pressure at blower TSV 1410 lbf/in²
 HP steam temperature at blower TSV 392°C
 LP steam pressure at main TSV 550 lbf/in²
 LP steam temperature at main TSV 391°C
 Feedwater temperature 180°C

Fuel

Number of fuel channels per reactor 3876
 Number of elements per channel 7
 Dimensions of uranium rod 38.3 in x 1.10 in dia
 Total weight of uranium per reactor 300 tonne

Core dimensions

Diameter of active core 45 ft 4½ in
 Height of active core 24 ft 4½ in
 Diameter of reflector 50 ft
 Height over reflectors 28 ft
 Lattice (square) pitch 7.75 in
 Channel diameter 3.875 in

Gas circuit

Mean diameter of reactor vessel 62 ft 6 in
 Reactor vessel general thickness 4 in
 Gas working pressure 283 lbf/in²
 Number of gas circuits per reactor 4
 Diameter of gas ducts 6 ft 6 in
 Power input per blower 7 MW
 Overall height of boilers 75 ft
 Internal diameter of boilers 23 ft 6 in
 Shell thickness (graded) ¾ in to 2½ in

Turbo-alternators

Number of main turbo-alternators 4
 Continuous maximum rating/set 142.5 MW
 Speed 1500 rev/min
 Generator voltage 13.8 kV
 Vacuum 28.9 in Hg
 Exhaust wetness 14.3%
 Total circulating water quantity 353,000 gal/min

Layout

Distance between reactor building centres 426 ft
 Length of reactor building 316 ft
 Length of turbine house, only 358 ft

Legend

- Control Area**
- Entrance to change room
 - Personnel bridge
 - Cable flume
 - Mess room
 - Battery room
 - Control rod panels
 - Main control
 - Supervisors desk
 - Control desk
 - Control rod position panel
 - Boiler panels
 - Safety panel
 - Essential supplies panel
 - Reactor panels
 - Instrument room
 - Control room ventilation plant room
- Blower House Area**
- Reheat to boilers
 - H.P. steam to blower turbines
 - Blower
 - Blower turbine
 - Blower main oil tanks
 - Oil coolers
 - Blower & boiler gauging boards
 - 20 ton blower house crane
- Boiler House Area**
- L.T. economizer by-pass valve
 - H.P. economizer inlet
 - LP economizer inlet
 - LP economizer outlet
 - H.P., L.T. economizer outlet
 - H.P. feed mains
 - H.P. feed regulating valve
 - LP feed
 - H.T. economizer by-pass valve
 - LP evaporator inlet
 - LP evaporator outlet
 - H.T. economizer inlet
 - H.T. economizer outlet
 - H.P. evaporator inlet
 - H.P. evaporator outlet
 - LP superheater inlet
 - LP superheater outlet
 - Reheater inlet
 - Reheater outlet
 - LP superheater inlet
 - LP superheater outlet
 - Boilers
 - LP steam drum
 - H.P. steam drum
 - Boiler steam drum relief valves
 - Boiler CO₂ relief valves & filters
- CO₂ Duct Areas**
- Expansion bellows
 - CO₂ duct supports
 - Reactor CO₂ isolating valves
 - Isolating valve drives
 - Shield cooling fan suction ducts
 - CO₂ by-pass ducts
 - CO₂ by-pass isolating valve
 - Duct valve remote operating room
 - Inlet duct isolating valve drive
 - Debris removal duct
 - Shield cooling air inlet ring main
 - Shield cooling air inlet annular duct
 - Pressure vessel supports
 - Reactor CO₂ inlet ducts
 - Diagrid & debris collector
 - Gas seal
 - Pressure vessel
 - Thermocouple branch pipe
 - Graphite core
 - Core restraining structure
 - Fuel elements
 - Control rods
 - Charge pans
 - Reactor CO₂ outlet ducts
 - b.s.d. tube nest
 - Charge chute
 - Pile cap
 - Reactor control standpipes
 - Reactor charge standpipes
 - Charge machine chute headbox
 - Charge machine gantry
 - Charge machine power supply
 - Charge machine
 - Reactor television camera
 - 20 ton charge machine crane
 - Charge machine control room
 - Domestic ventilation plants
 - Shield cooling exhaust stack
 - Shield cooling fan
 - Shield cooling filter room
 - Shield cooling suction chamber
 - Sub-change entry to pile-cap
 - Burst cartridge detection room
 - Control rod control room
 - Essential supplies switch-gear room
 - Thermal column
 - Ion chamber room
 - Cable flat
 - Switchgear
 - Lift loading bay
 - Transformer bays

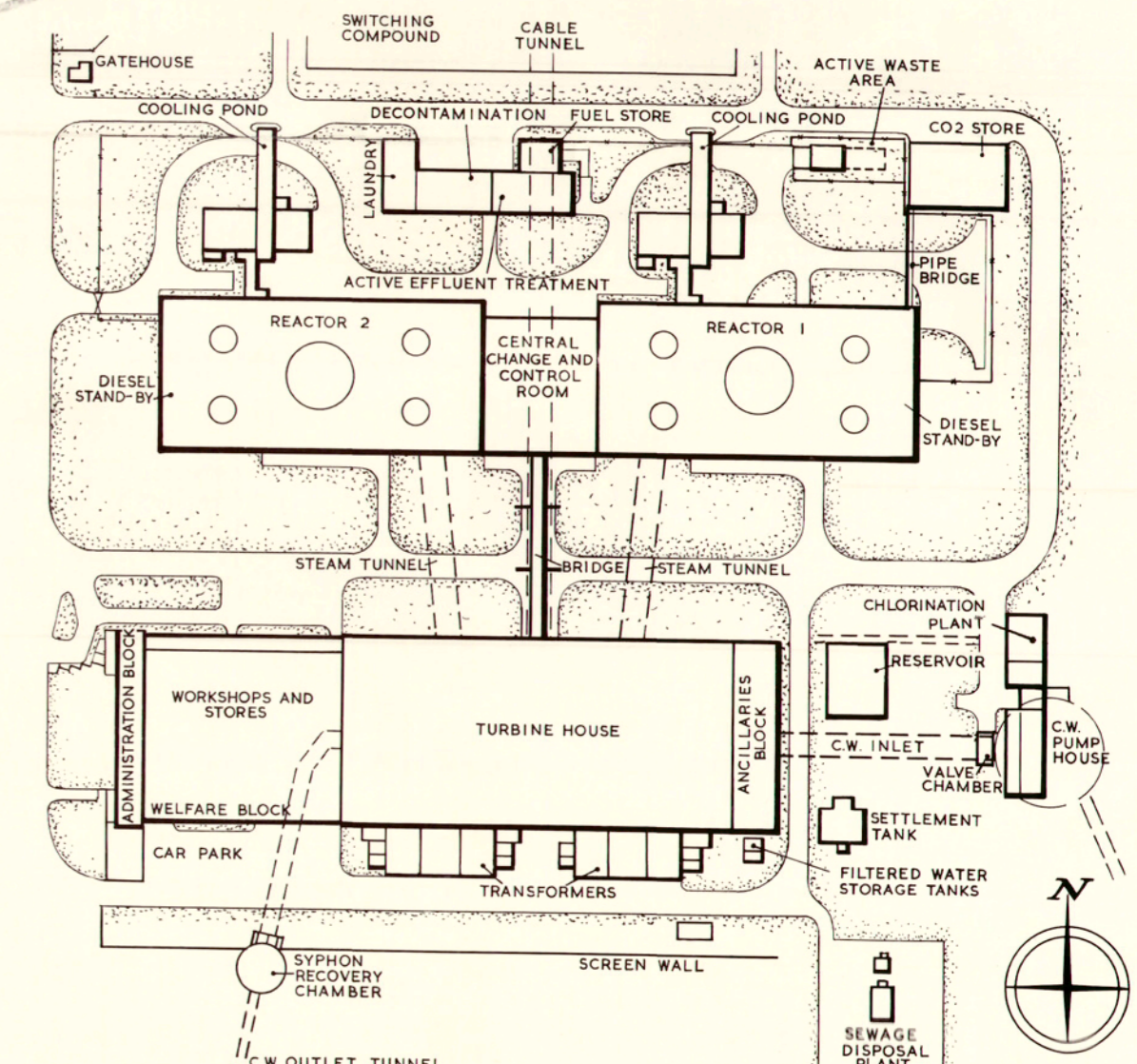
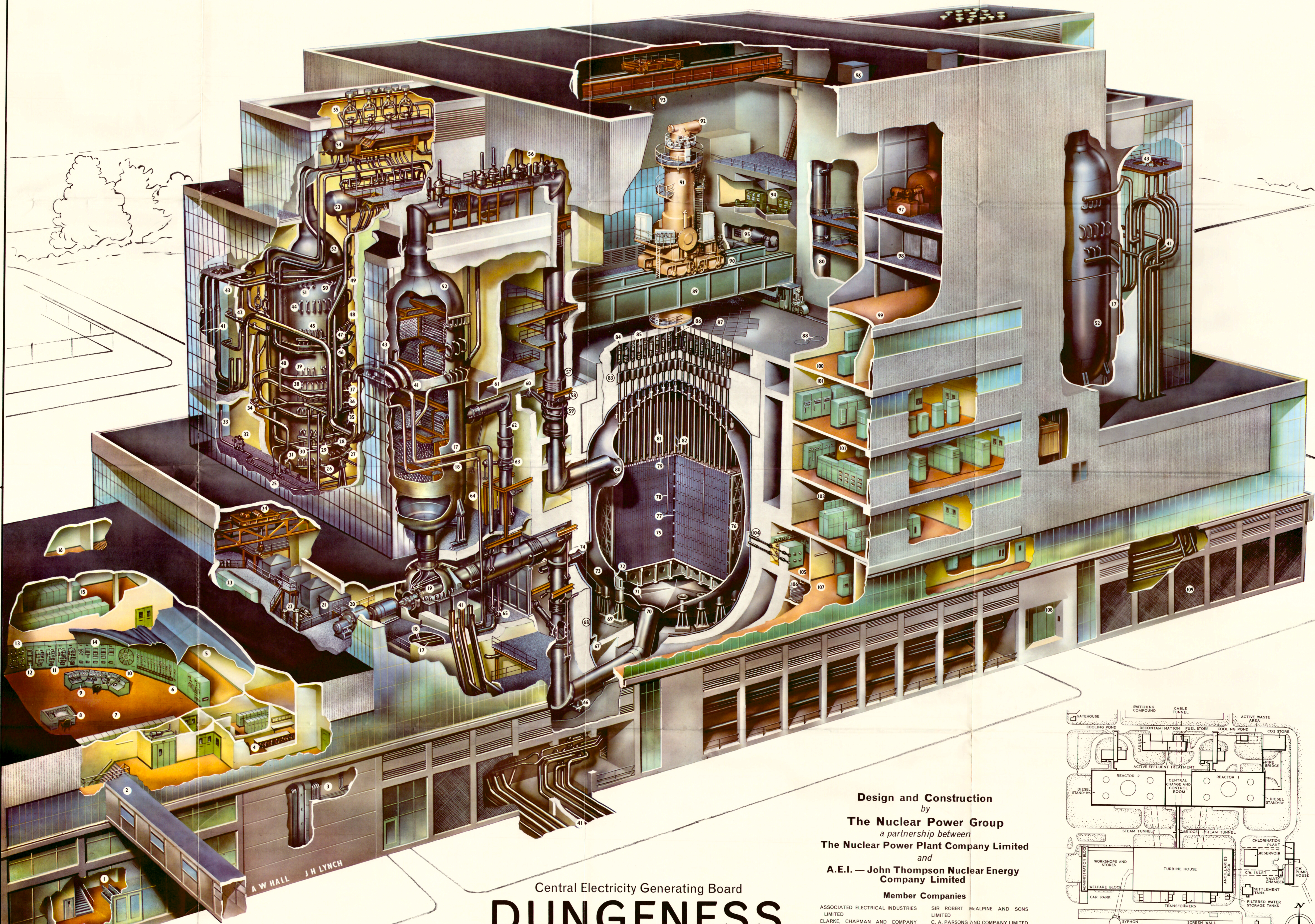

Design and Construction
 by
The Nuclear Power Group
 a partnership between
The Nuclear Power Plant Company Limited
 and
A.E.I. — John Thompson Nuclear Energy Company Limited
 Member Companies

- ASSOCIATED ELECTRICAL INDUSTRIES LIMITED
 CLARKE, CHAPMAN AND COMPANY LIMITED
 ALEX. FINDLAY AND COMPANY LIMITED
 HEAD, WRIGHTSON AND COMPANY LIMITED
- SIR ROBERT McALPINE AND SONS LIMITED
 C. A. PARSONS AND COMPANY LIMITED
 A. REVOLLE AND COMPANY LIMITED
 STRACHAN AND HENSHAW LIMITED
 JOHN THOMPSON LIMITED
 WHESSELO LIMITED

Central Electricity Generating Board DUNGENESS Nuclear Power Station

This drawing, copyright NUCLEAR POWER, was published in the April, 1961, issue.

Nuclear Power NUCLEAR POWER is published monthly. Annual subscription costs £2.20 UK and overseas (US and Canada \$8.00). Students £1 (\$3.00). Write to: Rowse & Muir Publications Ltd., The Rowse Muir Building, 77-79 Charlotte Street, London, W1, England